

— — A Special Report — —

Dear Friends,

October 1987

We have spoken to many of you at church meetings recently, explaining how you could help us at Fern Lodge—metaphysically, financially, and as volunteers. We continue to be blessed by your metaphysical support and by the wonderful assistance of our many volunteers. Now we are writing to keep you updated on our financial needs.

We have just broken ground for a major addition to Fern Lodge. The new wing will not only increase our capacity, but will also improve the quality of our care. We are excited that this long-anticipated project is now under way. But, it presents us with a major financial challenge.

The annual benevolence given at Fern Lodge has reached \$200,000. We presently rely on donations from the field to meet this operating expense. However, monthly donations do not always cover the monthly need. So this past year we have also been using interest earned by our Building Fund to provide benevolence. With this Fund now going toward construction costs, we must find another source of income for benevolence.

Our financial needs at this moment are twofold: (1) within the next 6 months we need to raise \$450,000 to pay for completion of our new addition and to provide the benevolence needed by our patients this fiscal year which ends July 31, 1988; and (2) within the next two years we need to raise an additional two million dollars to build up our Benevolence Endowment Fund to the point that it can substantially provide the needed benevolence and reduce our present reliance on donations from the field to meet this operating cost. In brief, then, our financial needs are:

\$250,000	Complete and furnish the new wing
200,000	Supply the benevolence needed this year
<u>2,000,000</u>	Establish an effective Benevolence Fund.
\$2,450,000	Contributions needed over the next 2 years
\$450,000	Of these contributions are needed before July 1, 1988

Thank you very much for your prayer in support of Christian Science nursing. And thank you for your financial contribution over the years as well as for your giving to our current projects. As we work together we will see the mission of nursing grow in its contribution to Christian Science healing.

Sincerely,

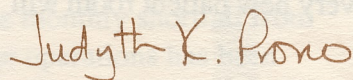

Judyth K. Prono, President

The Fern Lodge Board of Directors

President, Judyth K. Prono, Livermore; Vice-President, Blair Lindsay, Oakland; Treasurer, Bill Wood, Oakland; Secretary, Hazel Wilson, Hayward
Directors: Ray H. Bishop, Walnut Creek; Margaret Curtis, Walnut Creek; Mary Farnum, Walnut Creek

Expansion Under Way

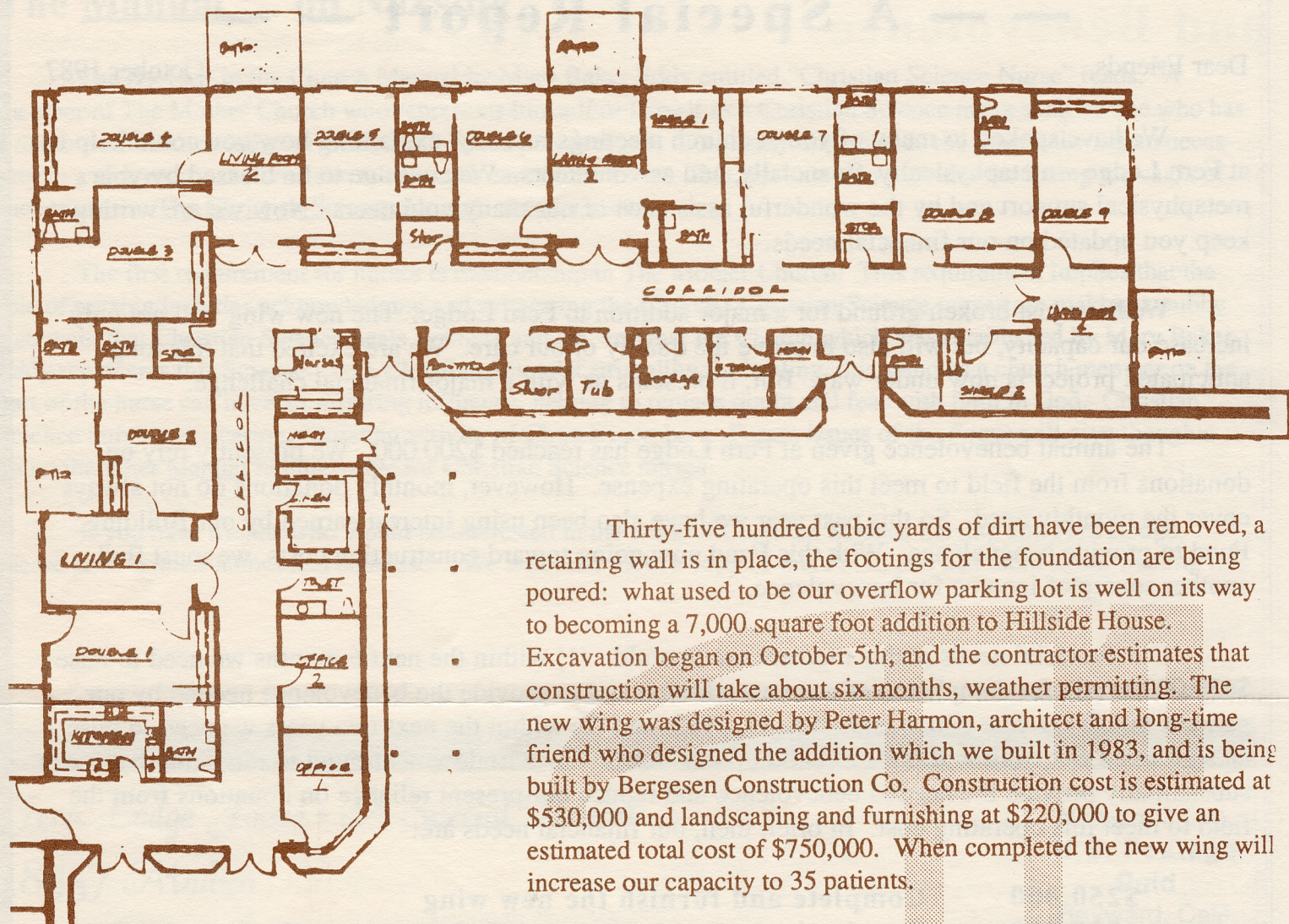

Thirty-five hundred cubic yards of dirt have been removed, a retaining wall is in place, the footings for the foundation are being poured: what used to be our overflow parking lot is well on its way to becoming a 7,000 square foot addition to Hillside House. Excavation began on October 5th, and the contractor estimates that construction will take about six months, weather permitting. The new wing was designed by Peter Harmon, architect and long-time friend who designed the addition which we built in 1983, and is being built by Bergesen Construction Co. Construction cost is estimated at \$530,000 and landscaping and furnishing at \$220,000 to give an estimated total cost of \$750,000. When completed the new wing will increase our capacity to 35 patients.

A goal of Fern Lodge is to keep a homelike atmosphere as we grow to give care for more who have a need. We have long realized that our facility is too crowded to afford the privacy which patients deserve. Many rooms which house two patients would better serve one. These rooms have bathrooms between them with their only entrance from the main hallway, not from the bedrooms. There is insufficient storage to maintain the clean appearance, inside and out, that we would like to present at all times. Also, to increase nursing effectiveness and fire safety, we should free Creekside House from all patient care.

The drawing shows the floor plan of our new wing. It incorporates several design ideas to improve the atmosphere of Fern Lodge. The new wing will have space for 20 patients, housed in 2 single and 9 spacious double rooms, each with its own bathroom. These rooms will have an adjacent private living room space, so patient rooms will not all exit into a long, empty hallway. The resulting building will feel more like home. Every new patient room will also have direct access to the outdoor patios, paths and gardens.

The new wing will enable us to change to single occupancy those double rooms in the Hillside House that are too small for two people. The current patient rooms in Creekside will be used for staff dining, reading and rest areas. There will also be space there for a permanent On-Job-Training Classroom, an addition which has regularly been suggested by The Mother Church at our accreditation visits. With staff activities out of Hillside House, we will have additional space there for a much needed Patient Activities room and an office for our dedicated Director of Volunteer and Patient Activities.

The Balance: Medi-Cal and Benevolence

The nursing care given at Fern Lodge is not paid for by Medicare, the Federal hospitalization insurance program, and few insurance policies cover a significant part of the cost. Our patients are either private, paying the full cost of their room, board and nursing care, or receive benevolence. Many who need benevolence are assisted by Medi-Cal, a State-run welfare program designed for those who need nursing care but are unable to pay for it. Help is available to individuals with less than \$1,700 in assets. Under this program, the State supplements what the patient is able to pay, but only to about \$55 per day. Since the cost of care at Fern Lodge is about \$97 per day, the result is a shortfall of about \$1,275 per month for every patient on Medi-Cal.

About two-thirds of the applicants for admission to Fern Lodge are Christian Scientists who ask for assistance from the Medi-Cal program. Some who are able to pay the cost of their care soon require Medi-Cal assistance to continue their stay. As a result about 70% of our patients are supported in part by Medi-Cal. Fern Lodge is unique in readily accepting patients supported by welfare funds through the Medi-Cal program. However, this presents us with a monthly shortfall of up to \$22,000. At the moment, we rely on donations from the field to make up this short fall.

Endowment Update

Recognizing that the monthly shortfall from our operations has been steadily growing over the past few years, Fern Lodge established a Benevolence Endowment Fund in 1985. Interest from this Fund is

to be used to help patients pay the cost of their nursing care. It was — and still is — our hope that this Fund will one day substantially offset the Medi-Cal shortfall. Because the monthly shortfall has been exceed-

Laurel Haven Gift

In 1984 Laurel Haven Sanitorium in San Mateo closed their doors and sold their facility. At that time Laurel Haven, Arden Wood, and Fern Lodge, the three Bay Area nursing facilities serving Christian Scientists, agreed that an urgent need in our community was for the kind of care offered at Fern Lodge. There continues to be this need for nursing care given without regard to the length of an individual's stay or to his or her ability to pay the cost of care. For this reason the money from the sale of Laurel Haven, a total of more than \$600,000, was given to Fern Lodge for the specific purpose of expansion. With this gift we established a Building Fund. During the past 3 years we have purchased property adjacent to our facility for \$125,000 and have had building plans approved by building officials, the fire department and our neighborhood. Each of these steps presented challenges, but all challenges have been harmoniously resolved. We are now building.

We are grateful to Laurel Haven for their generous gift. At this time we also extend our thanks to Arden Wood for their support and encouragement, and we look forward to continued close cooperation in the healing work of Christian Science nursing. Over the years a unique partnership has developed between Fern Lodge and Arden Wood. The cooperative efforts of our two facilities have ensured that a broad range of Christian Science nursing care is available for our community.

ing donations from the field, we have not been able to build up the Endowment Fund. Its current balance is \$1,200. Over the next two years, our goal is to raise \$2,000,000 for the Endowment Fund so that the

interest derived from it will largely supply the needed benevolence. Our ultimate goal is to be sufficiently endowed to eliminate reliance on State Medi-Cal funds entirely.

The Manual ... on Nursing

The By-Law in the Church Manual by Mary Baker Eddy entitled "Christian Science Nurse" reads, "A member of The Mother Church who represents himself or herself as a Christian Science nurse shall be one who has a demonstrable knowledge of Christian Science practice, who thoroughly understands the practical wisdom necessary in a sick room, and who can take proper care of the sick." This By-Law also provides for listing the cards of such nurses in The Christian Science Journal. (Manual, p. 49.)

The first requirement for nurses is membership in The Mother Church. This requirement implies that the role of nursing includes acknowledging and supporting the Church. Christian Science nurses are making a public statement that Christian Science heals sickness and sin, and that the Church which was established by Mary Baker Eddy represents this Science. To a Christian Scientist struggling for healing, this stand as a church member on the part of the nurse can have an inspiring influence, helping to replace doubt and fear with faith in God. Christian Science nursing is a caring, Christian activity of Church members. Future issues of the *Focus* will give thoughts about the other Manual requirements for Christian Science nurses.

If you have friends who would be interested in the work of Christian Science nursing and Fern Lodge, please send us their names and addresses. We will send them a copy of this *Focus* and add them to our mailing list.

Fern Lodge Focus - A Special Report
18457 Madison Avenue
Castro Valley, CA 94546-1699

Non-profit Org.
U.S. Postage
Paid
Hayward, Calif.
Permit No. 798



address correction requested